

Protecta FR Acrylic 150mm Solid Timber or CLT Floor Steel, Copper, Alupex Bare Pipes

Installation Instructions

1. Before installing Protecta® FR Acrylic ensure that the surface of all service penetrations and surrounding construction is free from all loose contaminants, dust and grease.
2. Install the backing material. Cut this slightly oversize and insert into the gap ensuring a tight friction fit. Ensure correct depth is achieved.
3. Fill the gap or joint with Protecta® FR Acrylic on both sides to the required depth.
4. Apply the sealant generously to prevent air bubbles. Finish the bead with a moist spatula, pallet knife or brush.
5. Protecta® FR Acrylic can be over-painted with most emulsion or alkyd (gloss) paints.

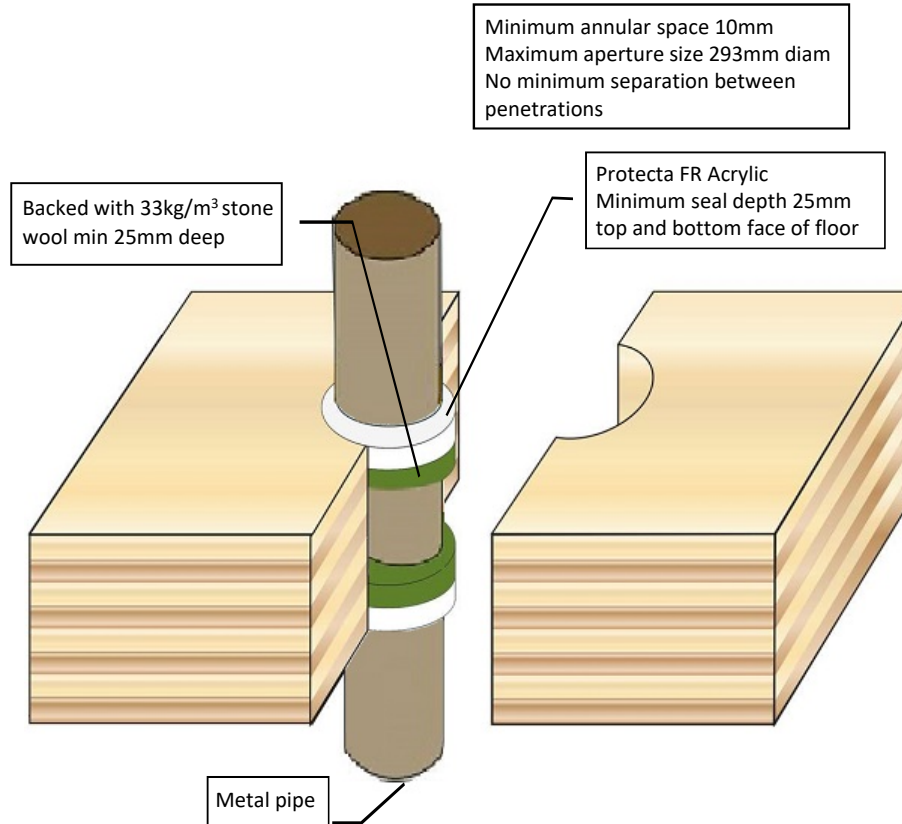

System/FPA Register ID# FC415

Products	Protecta FR Acrylic Stone wool
Application	Fire stopping of bare metal pipes in timber floors
Construction	Minimum floor thickness of 150mm and comprise solid timber or CLT with a minimum density of 480kg/m³.

Fire & Sound classification

Steel pipe up to 273mm diam (up to 14.2mm wall)
FRR -/120/-

Copper pipe up to 54mm diam (up to 14.2mm wall)
FRR -/120/-

Alupex pipe up to 75mm diam (up to 4.6mm wall)
FRR -/120/-

ZERO smoke leakage up to 200Pa

Sound reduction (seal only) STC 62

Sheet size: **A4** | Drawn date & no: 24/5/21

Scale: **NTS** | Drawn by: K.B